

Inward Opening Rebated Threshold detail

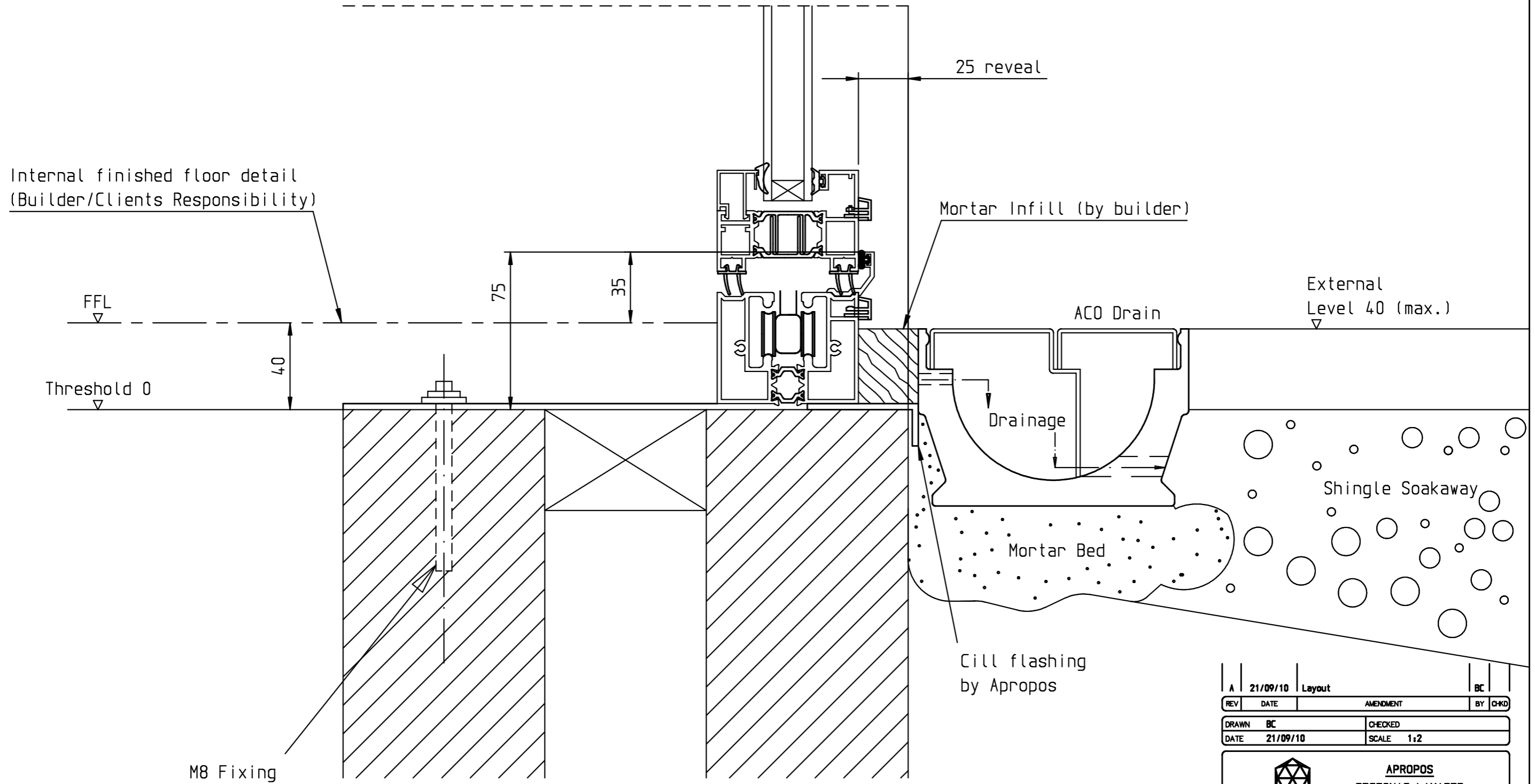

A	21/09/10	Layout	BC
REV	DATE	AMENDMENT	BY
DRAWN	BC	CHECKED	
DATE	21/09/10	SCALE	1:2

**APROPOS
TECTONIC LIMITED**
 Greenside House, Richmond Street,
 Ashton-under-Lyne, OL6 7ES
 ClearSpan Direct Line: 0161 342 8203
 ClearSpan Direct Fax: 0161 342 8265

PROJECT	ClearSpan Folding Sliding Doors	SIZE	A3
---------	---------------------------------	------	----